

One-touch spacer

YPS series (100pcs/pack)

- This spacer can be fit just by insertion. (Same usage as YP series)
- The amount of protrusion to the back side of chassis is lower than YP series (Space-saving type)
- This is used for fitting a PC board to a chassis and for mounting PC boards by two-tiered installation.
- In case of the dimension is fit, the material at the chassis side can be metal, resin and so on.
- YPS-3.5S is short height type.

- Material: Nylon 66 (UL94V-0)
- Color: WHITE
- Operating temperature range: - 20 to + 85°C

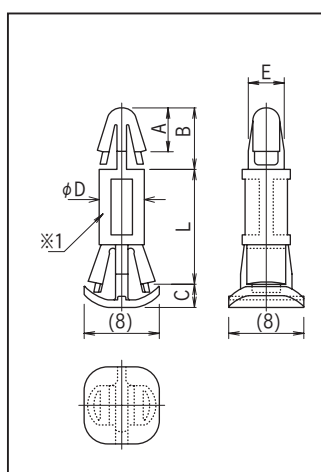

YPS- □

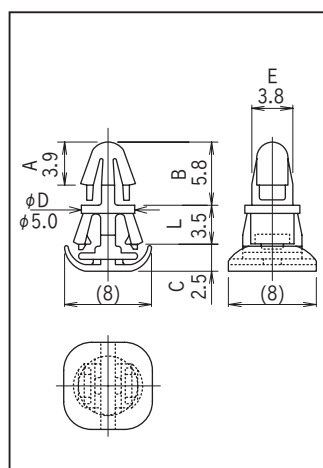

YPS-3.5S

*1: YPS-5, YPS-6 have different intermediate shapes.



YPS- □

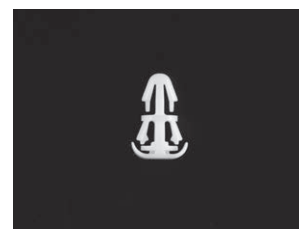

YPS-3.5S

■ Example of usage

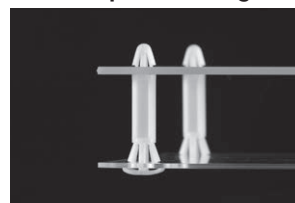

YPS- □
example of usage

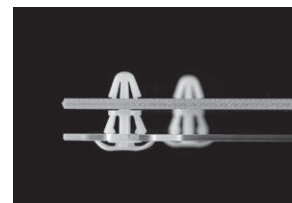

YPS-3.5S
example of usage

■ Part No.

Part No.	L	A	B	C	φ D	E	Fitting hole diameter		Adaptive thickness	
							PCB side	Chassis side	PCB side	Chassis side
YPS-3.5S	3.5	3.9	5.8	2.5	5.0	3.8	φ 4.0	φ 5.5	1.6	0.3 to 1.0
YPS-5	5.0	4.5	6.5	2.6	5.0	3.8	φ 4.0	φ 5.5	1.6	0.5 to 1.0
YPS-6	6.0	4.5	6.5	2.6	5.0	3.8	φ 4.0	φ 5.5	1.6	0.5 to 1.0
YPS-8	8.0	4.5	6.5	2.6	5.0	3.8	φ 4.0	φ 5.5	1.6	0.5 to 1.0
YPS-10	10.0	4.5	6.5	2.6	5.0	3.8	φ 4.0	φ 5.5	1.6	0.5 to 1.0
YPS-12	12.0	4.5	6.5	2.6	5.0	3.8	φ 4.0	φ 5.5	1.6	0.5 to 1.0
YPS-14	14.0	4.5	6.5	2.6	5.0	3.8	φ 4.0	φ 5.5	1.6	0.5 to 1.0
YPS-16	16.0	4.5	6.5	2.6	5.0	3.8	φ 4.0	φ 5.5	1.6	0.5 to 1.0
YPS-18	18.0	4.5	6.5	2.6	5.0	3.8	φ 4.0	φ 5.5	1.6	0.5 to 1.0
YPS-4M	6.2	4.0	6.0	2.2	4.6	3.0	φ 3.2	φ 4.8	1.6	0.5 to 1.0
YPS-8M	12.8	4.0	6.0	2.2	4.6	3.0	φ 3.2	φ 4.8	1.6	0.5 to 1.0