

Compact terminal for fitting electric cable {for SMT}

MMS series

- For fitting or disconnecting slight electric cable to and from SMT board.
- Possible to fit the low (small) electric cable to any place of SMT board.
- Material: Brass
- Finish: Gold plating over nickel base
- Fitting screw: M1.0 pan head screw ⊕ nickel plating (MMS-1-1)
M1.7 pan head screw ⊖ nickel plating (MMS-2-1)
- Fitting electric cable diameter (core wire) : ϕ 0.8 or less (MMS-1-1)
 ϕ 1.5 or less (MMS-2-1)
- Rated current: MMS-1-1.....10A
MMS-2-1.....20A

Instruction for use

- (1) MMS series comes with screws. (packed separately)
- (2) Please fix the electric cable with the screw after soldering

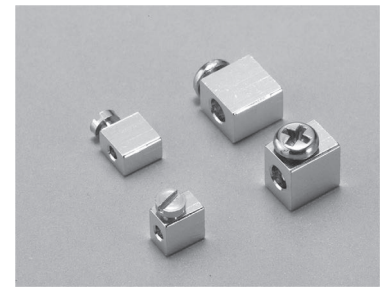

Example of usage

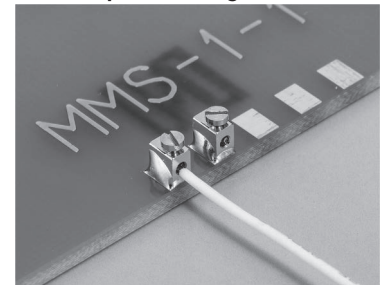

MMS-1-1

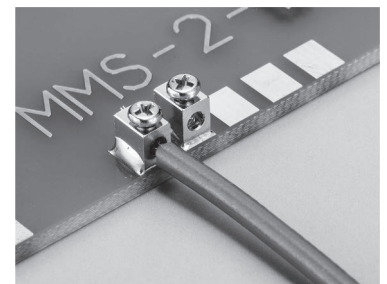

MMS-2-1

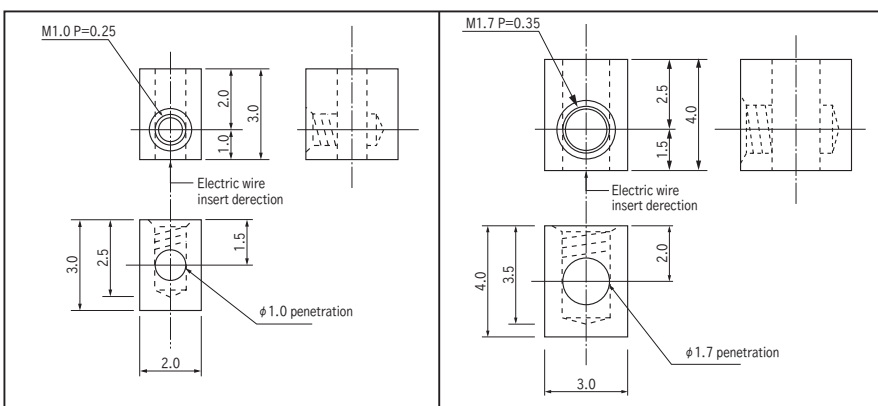

MMS-1-1

MMS-2-1

Part No.

| Part No. | Package |
|-----------|--------------------|
| MMS-1-1 | Bulk (100pcs/pack) |
| MMS-1-1-T | Reel (500pcs/reel) |
| MMS-2-1 | Bulk (100pcs/pack) |
| MMS-2-1-T | Reel (400pcs/reel) |

Recommended land information

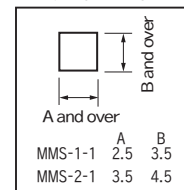

Dimension of the reel

