

Power supply terminal

PVT-3

- This is used for supplying power to PC board.
- Please mount by flow soldering or manual soldering.
- Please fit a crimping terminal at the edge of electric wire and tighten it with a M3 screw.
- Rated current is larger than PV-3 (Surface mounting type).
- Tensile strength and torsional strength is stronger than PV-3.
- Material: Copper
- Finish: Tin plating over nickel base
- Rated current: 40A

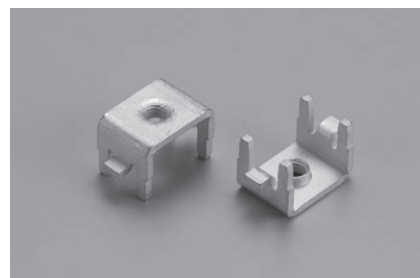

■ Part No.

Part No.	Package
PVT-3	Bulk (100pcs/pack)

■ Dimension

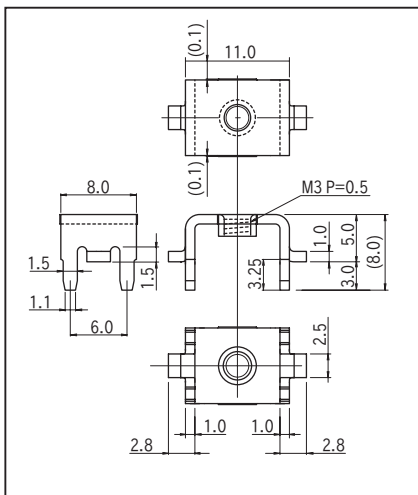

■ Example of usage

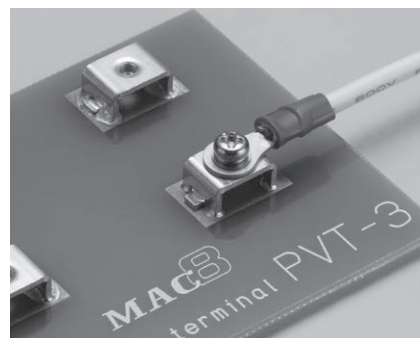

■ Tightening torque

6 kgf-cm (58.8N-cm) or less

■ Recommended land information

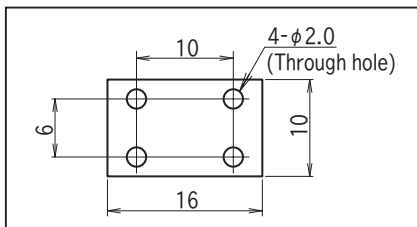

※ Recommended land diameter on the solder side is ϕ 2.8 or over, using the same full-pattern as the component side is also acceptable.

■ Instructions for use

If solder does not reach up to the component side, please add additional solder to address the issue.