

**Stopper fitting mount for a PC board [AXE series] (10pcs/pack)**

- This is used with a hinge for PC board (AXC series) to fix a PC board.
- M3 and  $\phi$  3.2 are available for the fitting side.
- Material Resin part: PBT black (UL94V-0)  
Screw part: Brass (Nickel plating)
- Insulation resistance: 500M $\Omega$  or over
- Withstand voltage: 1000V AC, DC per minute
- Operating temperature range: -40 to +125°C

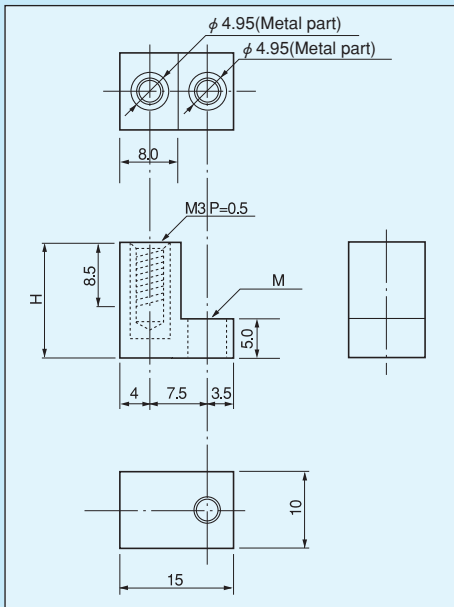

**Example of usage**

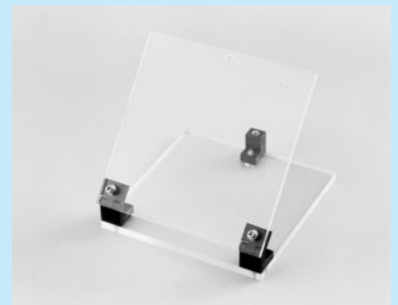

Combination with AXC series

**Part number**

Part number	H	M
AXE-15-3.2	15	3.2 $\phi$
AXE-15-M3	15	M3
AXE-20-3.2	20	3.2 $\phi$
AXE-20-M3	20	M3
AXE-25-3.2	25	3.2 $\phi$
AXE-25-M3	25	M3
AXE-30-3.2	30	3.2 $\phi$
AXE-30-M3	30	M3

- M3.....M3 P=0.5
- 3.2: With an unloaded hole of  $\phi$  3.2 (without metal part)