

Terminal for hybrid IC

CB-7 series (1000pcs/reel)

- This terminal can be fit with a pitch of 2.54 mm to a PC board.
- This is supplied in the reel form with a pitch of 2.54 mm
- Material: Phosphor bronze
- Finish: Tin plating over nickel base

■ Part No.: CB-7-1

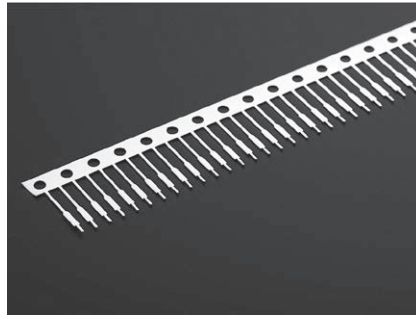
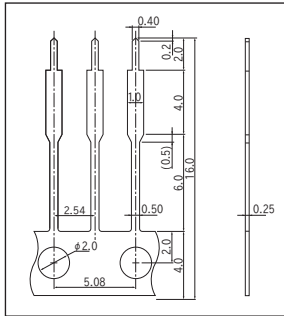

- Recommended fitting hole:
Upper side: ϕ 0.7 TH
Lower side: ϕ 0.8 TH

■ Part No.: CB-7-2

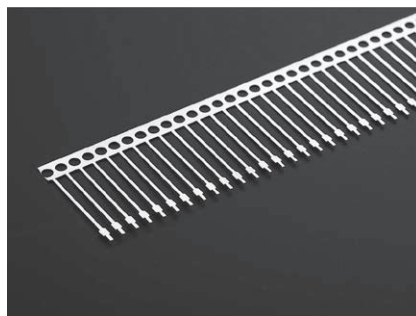
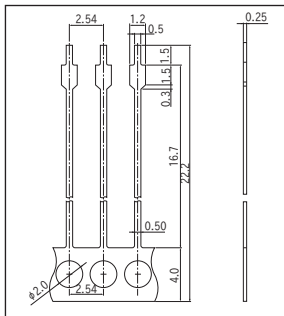

- Recommended fitting hole:
 ϕ 0.8 TH

■ Part No.: CB-7-3

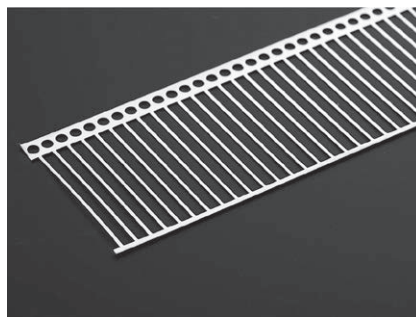
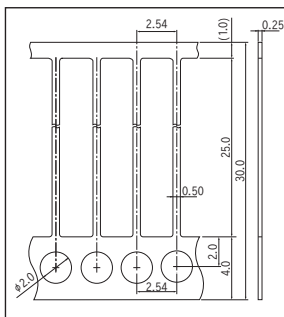

- Recommended fitting hole:
 ϕ 0.8 TH

Jig for fitting the terminal

CBX series (1pc/pack)

Tool

- This terminal can be fit with a pitch of 2.54 mm to a PC board.

■ Part No.

CBX-100 (for CB-1, CB-3 series)

CBX-200 (for CB-2, CB-4 series)

Example of usage

