

**Connection pin for surface mounting(Pitch: 1.27, 1.778, 2.54 mm)**

**OQ series (10pcs/pack)**

- This is used as a male pin for surface mounting board, ceramic board, aluminum board, iron board and other boards on which it is impossible to drill a hole.
- This can also be used as the leg of Hybrid IC, etc.
- 40P connected with a pitch of 1.27 mm, 32P connected with a pitch of 1.778 mm, 20P connected with a pitch of 2.54 mm
- Material
  - Resin part: PCT black (UL94V-0)
  - PPS black (UL94V-0) (OQ-01, OQ-03, OQ-43 series only)
  - Pin part: Phosphor bronze (OQ-01, OQ-03, OQ-11, OQ-12, OQ-13 series), Brass (OQ-21, OQ-22, OQ-23, OQ-43 series)
- Finish: Gold plating over nickel base
- Rated current:
  - OQ-01, OQ-03, OQ-11, OQ-12, OQ-13 series: 2A
  - OQ-21, OQ-22, OQ-23 series: 3A
  - OQ-43 series: 5A
- Insulation resistance: 500 M Ω or over
- Withstand voltage: 700V AC, DC per minute (OQ-01, OQ-11, OQ-21 series)
- 1000V AC, DC per minute (the rest)
- Operating temperature range: - 40 to + 125 °C

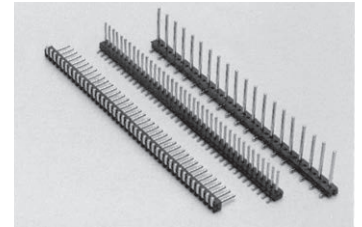

**Part No.**

Part No.	A	B	C	D	E	P	Maximum number of pins connected
OQ-01-4.2	4.2	1.5	0.4	0.635	50.8	1.27	40
OQ-01-5	5	1.5	0.4	0.635	50.8	1.27	40
OQ-01-6.5	6.5	1.5	0.4	0.635	50.8	1.27	40
OQ-11-3.8	3.8	1.5	0.45	0.635	50.8	1.27	40
OQ-11-4.2	4.2	1.5	0.45	0.635	50.8	1.27	40
OQ-11-5	5	1.5	0.45	0.635	50.8	1.27	40
OQ-11-6.5	6.5	1.5	0.45	0.635	50.8	1.27	40
OQ-12-3.8	3.8	1.5	0.45	0.889	56.89	1.778	32
OQ-12-4.2	4.2	1.5	0.45	0.889	56.89	1.778	32
OQ-12-5	5	1.5	0.45	0.889	56.89	1.778	32
OQ-12-6.5	6.5	1.5	0.45	0.889	56.89	1.778	32
OQ-03-4.2	4.2	1.5	0.4	0.635	49.53	2.54	20
OQ-03-5	5	1.5	0.4	0.635	49.53	2.54	20
OQ-03-6.5	6.5	1.5	0.4	0.635	49.53	2.54	20
OQ-13-3.8	3.8	1.5	0.45	0.635	49.53	2.54	20
OQ-13-4.2	4.2	1.5	0.45	0.635	49.53	2.54	20
OQ-13-5	5	1.5	0.45	0.635	49.53	2.54	20
OQ-13-6.5	6.5	1.5	0.45	0.635	49.53	2.54	20
OQ-21-5	5	1.5	0.6	0.8	51.13	1.27	40
OQ-21-8	8	1.5	0.6	0.8	51.13	1.27	40
OQ-21-10	10	1.5	0.6	0.8	51.13	1.27	40
OQ-21-12	12	1.5	0.6	0.8	51.13	1.27	40
OQ-21-15	15	1.5	0.6	0.8	51.13	1.27	40
OQ-22-5	5	1.5	0.6	0.889	56.89	1.778	32
OQ-22-8	8	1.5	0.6	0.889	56.89	1.778	32
OQ-22-10	10	1.5	0.6	0.889	56.89	1.778	32
OQ-22-12	12	1.5	0.6	0.889	56.89	1.778	32
OQ-22-15	15	1.5	0.6	0.889	56.89	1.778	32
OQ-23-5	5	1.5	0.6	0.8	49.86	2.54	20
OQ-23-8	8	1.5	0.6	0.8	49.86	2.54	20
OQ-23-10	10	1.5	0.6	0.8	49.86	2.54	20
OQ-23-12	12	1.5	0.6	0.8	49.86	2.54	20
OQ-23-15	15	1.5	0.6	0.8	49.86	2.54	20
OQ-43-8	8	2.0	1.0	1.27	50.8	2.54	20
OQ-43-10	10	2.0	1.0	1.27	50.8	2.54	20
OQ-43-12	12	2.0	1.0	1.27	50.8	2.54	20
OQ-43-15	15	2.0	1.0	1.27	50.8	2.54	20

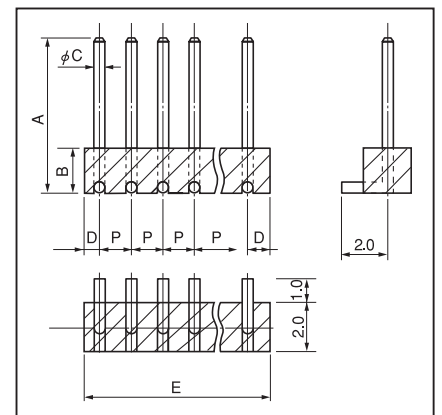

**Recommended land information**

• OQ-01, 11 series

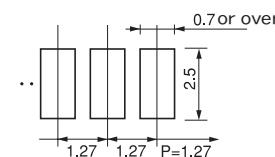

• OQ-12 series

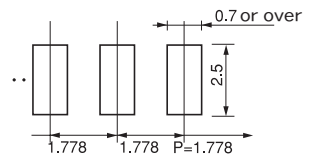

• OQ-03, 13 series

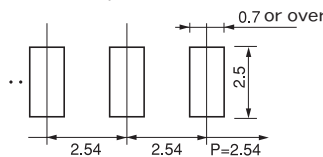

• OQ-21 series

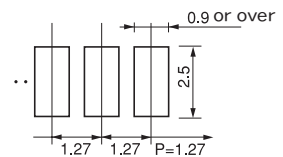

• OQ-22 series

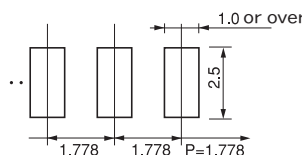

• OQ-23 series

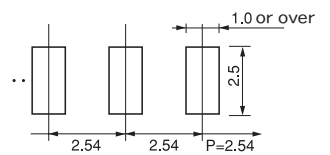

• OQ-43 series

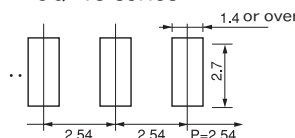

**How to order**

OQ-11-4.2-10P



Please fill in the desired number of poles.

\* If the number of pins is not specified, we will deliver by the maximum number of pins connected.

**Instructions for mounting**

In the case that a warpage occurs on the resin part during reflow because many pins are connected for use, apply an adhesive to several places.