

### Lever-type electric wire installation terminal

Part No.: **WX-4-2** (10pcs/pack)

- This terminal connects and fixes electric wire without soldering it to a board.
- Attaching and detaching of electric wire can be easily done just by operating the upper lever. (No screwdrivers and other exclusive jigs are required.)
- Material Lever part: Stainless steel  
 Inner spring: Stainless steel  
 Upper body: Copper: Tin plating over nickel base  
 Lower body: Phosphor bronze: Tin plating over nickel base
- Adaptive electric wire: AWG28 to AWG20 (standard wire)
- Covering peeling length: 7mm  
 (Please fix the shape of stripped electric wire to some extent and insert.)
- Rated current: 8A (When soldering the both legs)
- PC board fitting hole diameter:  $\phi$  1.4
- Operating temperature range: - 40 to +125°C

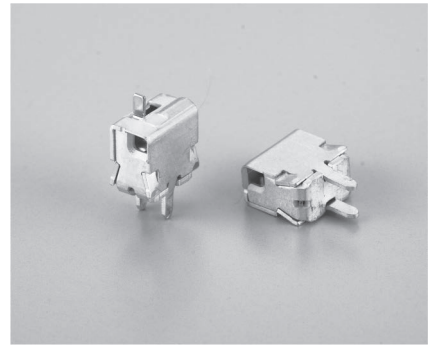

#### ■ Example of usage

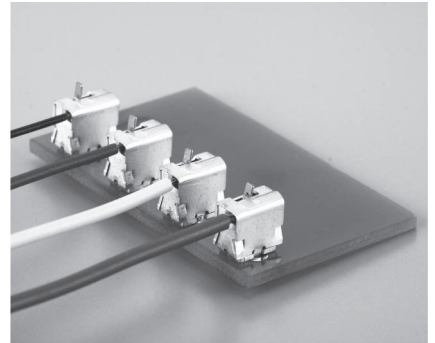

#### ■ Part No.

WX-4-2

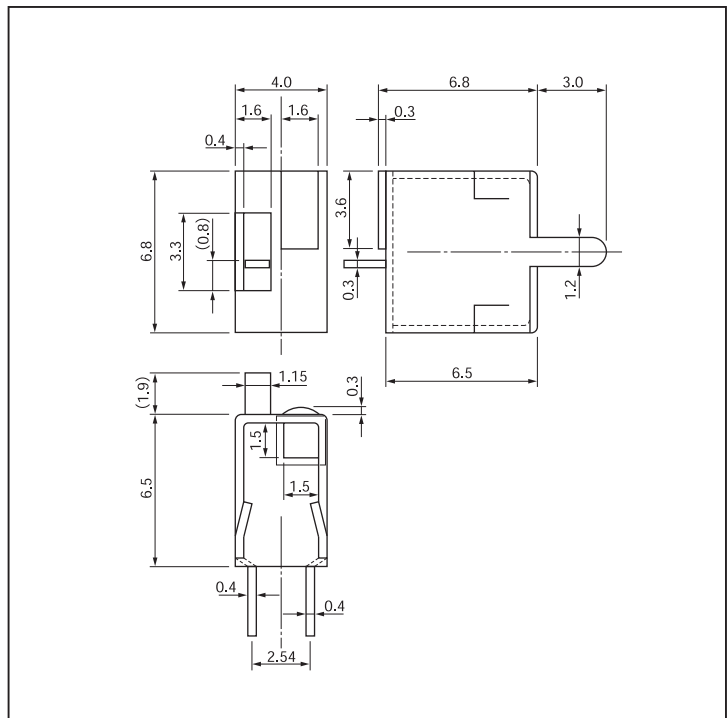

#### \* Attention

- Please avoid washing as a whole because it may affect the inner contact face.