

Resin type

Spacer of hollow shape for printed board

EM series (100pcs/pack)

- This is used for fitting a printed board to a chassis, and other adaptive cases.
- This can be used as an LED spacer. (LED head diameter: ϕ 5)
- Material: Bakelite
- Color: BROWN (The color is uneven due to the nature of resin.)
- Operating temperature range: $- 40$ to $+ 120^{\circ}\text{C}$



Example of usage

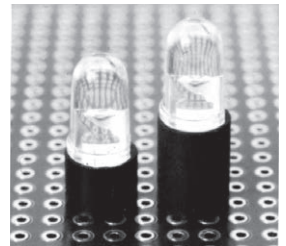

Part No.	L
EM-1-A	1
EM-1.5-A	1.5
EM-2-A	2
EM-2.5-A	2.5
EM-3-A	3
EM-3.5-A	3.5
EM-4-A	4
EM-4.5-A	4.5
EM-5-A	5
EM-6-A	6
EM-7-A	7
EM-7.5-A	7.5
EM-8-A	8
EM-9-A	9
EM-10-A	10
EM-11-A	11
EM-12-A	12
EM-12.5-A	12.5
EM-13-A	13
EM-14-A	14
EM-15-A	15
EM-17.5-A	17.5
EM-20-A	20
EM-25-A	25
EM-30-A	30

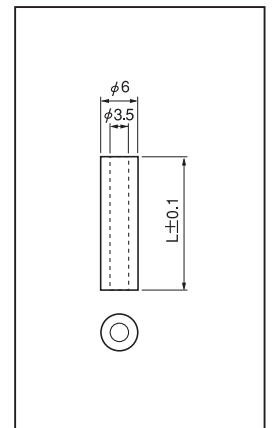

- The color has been changed from the conventional type (Part No.: without A) black to brown.