

## Printed Board vertical fitting clasp (for SMT) [AV-5 series]

- Fitting by soldering to SMT board, pushing sub plate in it, and fitting vertically.
- Please solder to the sub plate side for certain.
- For tape-and-reel type, please remove adsorption film after reflow.
- In case of hand soldering, we recommend to insert the product to the sub plate side and solder to the main plate side for fitting.
- Possible to fix the PCB, and flow the current.
- Material: Phosphor bronze
- Finish: Tin plating over Ni base
- Rated current: 20A

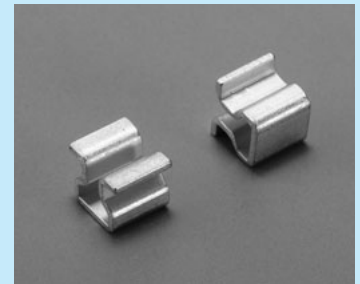

### Example of usage



### Dimension

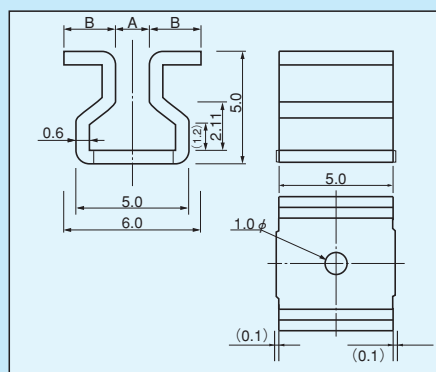

Part number	A	B
AV-5-0.6	0.5	2.75
AV-5-1.0	0.9	2.55
AV-5-1.6	1.5	2.25

### Recommended land diameter

#### ● Main plate side

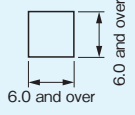

#### ● Sub plate side

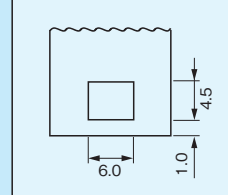

### Example of usage

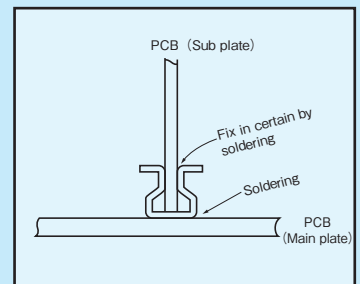

### Part number

Part number	Adaptive PCB thickness (mm)	Package
AV-5-0.6	0.6	Bulk(100pcs/pack)
AV-5-0.6-T	0.6	Reel(200pcs/reel)
AV-5-1.0	1.0	Bulk(100pcs/pack)
AV-5-1.0-T	1.0	Reel(200pcs/reel)
AV-5-1.6	1.6	Bulk(100pcs/pack)
AV-5-1.6-T	1.6	Reel(200pcs/reel)

- There is an adsorption film to the reel type

### Dimension of the reel

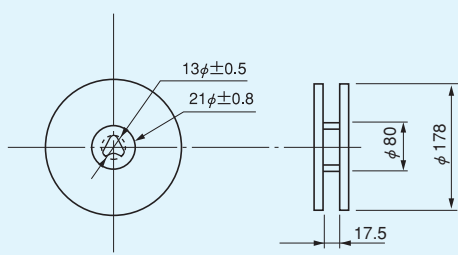

### Dimension of the tape

