

Jumper for high current

MJW series

- High current can be applied to this jumper.
- This is used for applying high current to a thick copper board, etc.
- Material: Copper
- Finish: Tin plating over nickel base
- Rated current: 60A

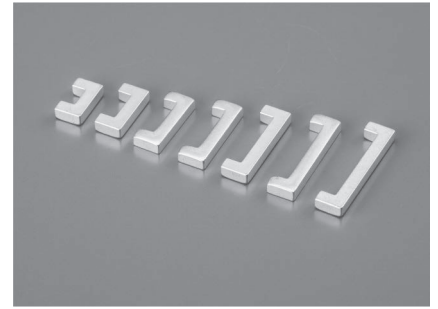

■ Part No.

| Part No. | L | A | Package | B | C | D | E | F | P | W |
|-----------|-------|-------|--------------------|------|-------|-----|------|------|-----|----|
| MJW-0.2 | 5.08 | 11.08 | Bulk (100pcs/pack) | | | | | | | |
| MJW-0.2-T | 5.08 | 11.08 | Reel (300pcs/reel) | 25.5 | 11.48 | 3.0 | 11.5 | — | 8.0 | 24 |
| MJW-0.3 | 7.62 | 13.62 | Bulk (100pcs/pack) | | | | | | | |
| MJW-0.3-T | 7.62 | 13.62 | Reel (300pcs/reel) | 25.5 | 14.02 | 5.0 | 11.5 | — | 8.0 | 24 |
| MJW-0.4 | 10.16 | 16.16 | Bulk (100pcs/pack) | | | | | | | |
| MJW-0.4-T | 10.16 | 16.16 | Reel (300pcs/reel) | 33.5 | 16.56 | 7.0 | 14.2 | 28.4 | 8.0 | 32 |
| MJW-0.5 | 12.70 | 18.70 | Bulk (100pcs/pack) | | | | | | | |
| MJW-0.5-T | 12.70 | 18.70 | Reel (250pcs/reel) | 33.5 | 19.10 | 9.0 | 14.2 | 28.4 | 8.0 | 32 |
| MJW-0.6 | 15.24 | 21.24 | Bulk (100pcs/pack) | | | | | | | |
| MJW-0.6-T | 15.24 | 21.24 | Reel (250pcs/reel) | 33.5 | 21.64 | 12 | 14.2 | 28.4 | 8.0 | 32 |
| MJW-0.7 | 17.78 | 23.78 | Bulk (100pcs/pack) | | | | | | | |
| MJW-0.7-T | 17.78 | 23.78 | Reel (200pcs/reel) | 45.5 | 24.18 | 14 | 20.2 | 40.4 | 12 | 44 |
| MJW-0.8 | 20.32 | 26.32 | Bulk (100pcs/pack) | | | | | | | |
| MJW-0.8-T | 20.32 | 26.32 | Reel (200pcs/reel) | 45.5 | 26.72 | 16 | 20.2 | 40.4 | 12 | 44 |

■ Dimension

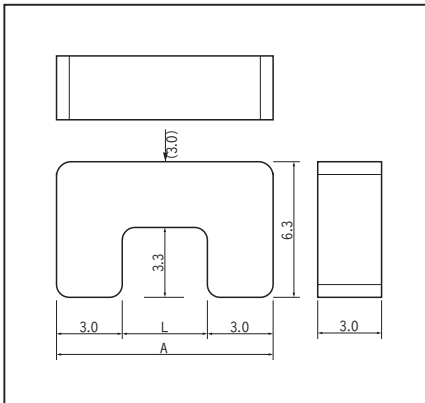

■ Recommended land information

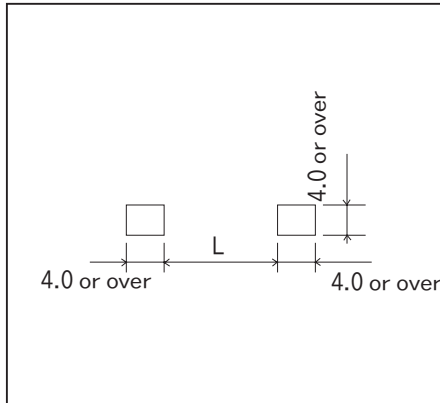

■ Example of usage

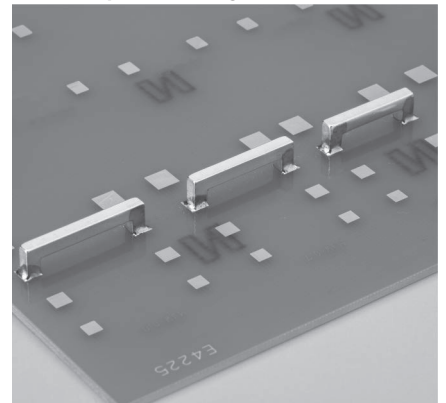

■ Dimension of the reel

