

# Micro Connector

- Conventionally connectors on a PC board are gathered at one place and taken out to the outside. However due to high-density mounting and reduction in size of the PCB recently it becomes difficult to gather signal lines at one place when designing the PCB layout.
- By using this micro connector, they can be separately taken out to the outside.
- As this connector is super-small type, it can be used when space is limited.
- The housing for 2.54mm pitch is also available.

## Combination

Male side (electric wire fitting side)

Female side (PC board side) (This is adaptive for other types.)

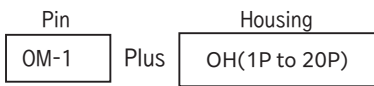
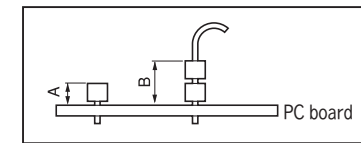

Part No.	Printed board fitting hole diameter	Height above the printed board part surface: A mm	Height above the housing + female pin part surface: B mm
PD-1	φ 0.6	4.2	8.7
PD-10	φ 0.6	4.2	8.7
PD-4	φ 1.4	0.8	5.3
PM-1	φ 0.6	4.2	8.7
PM-10	φ 0.6	4.2	8.7
PM-5	φ 0.6	2.5	2.5
PM-50	φ 0.6	2.5	2.5

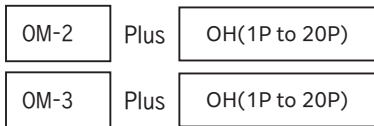

PD-7	1.0	0.4	4.9
PC-10	1.0	0.5	5.0

## Male pin

### OM series (100pcs/pack)

- This product and the housing (OH series) can be used as a pair.
- This product can be used alone (without housing).
- Please press-fit by using OM series press-fitting tool (OMXT-1).

Part No.	A	L	B	Adaptive female pin
OM-1	3.7	8.2	0.55	PD, PM series
OM-2	3.0	7.5	0.48	PD-7
OM-3	3.6	8.1	0.50	PC-10

- Material: Brass
- Finish: Gold plating over nickel base
- Electric capacity: 1A
- Mountable electric wire diameter: Thinner than AWG26
- Mounting housing: OH series

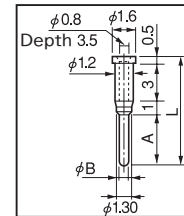

OM-1 OM-2

## Housing

### OH series (100pcs/pack)

- This housing is used for fixing OM-1, OM-2 and OM-3.
- The tool for press-fitting to the housing is OMXT-2 and OMXT-3.

Material	PBT resin (UL94V-0)
Color	Black
Temperature range	- 40 to + 125°C
Number of pins	Max. 20P
1st display	White marking

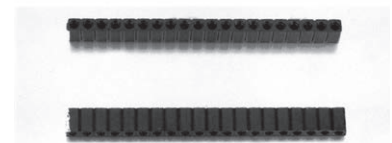
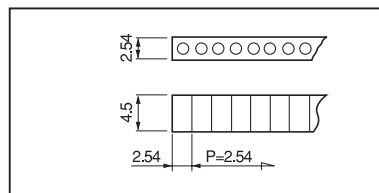

### How to order

OH-3

↑ Please fill in the desired number of poles. (Maximum number: 20P)